

Multi Function Night Light

SET - UP AND OPERATION

Increase safety around the home with our helpful Multi Function Night Light. Easy to use, water resistant and no need for batteries.

No assembly required



- ⚠ Please read these instructions before use
- ⚠ This light is for indoor use only
- ⚠ Do not use with an extension cord
- ⚠ Do not attempt to remove the top of the handheld light – it is permanently affixed

Unpacking your light

Remove all packaging before use. The light includes two separate sections:

- A** Base (plugs into a standard wall socket)
- B** Handheld torch (inserts into base).

⚠ Note, there are no plugs or cables needed to connect the two sections

To operate

⚠ For optimal results, charge the light for a minimum of 24 hours before use.

- 1 Plug base into your wall socket, ensuring the charger is upright.
- 2 Insert the handheld torch into the base, ensuring the switch is in the OFF position.
- 3 Turn on power source to commence induction charging (charge for at least 24 hours before initial use).
- 4 Once charged, slide the switch to either AUTO or ON.

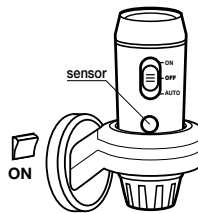
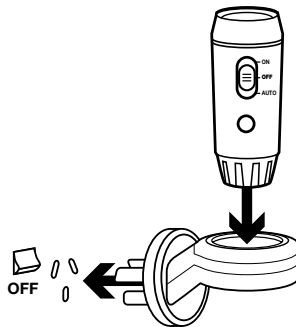

Bulbs

LED bulbs are non-replaceable. Do not attempt to remove the top or base of the handheld torch - it is permanently fixed.

Cleaning

Unplug the light and gently wipe with a dry or slightly damp cloth.

Specifications

ITEM	NL-UNL2
COLOUR	White
VOLTAGE	240V ~ 50Hz (Australian voltage)
BATTERY	Rechargeable 3.7V Lithium Ion battery (non-replaceable)
BULB	Non-replaceable LED light
LIFETIME	10,000 hours / 5 years (approximately)
WARRANTY	1 year
APPROVAL	CS8474N  N12298
MADE IN CHINA	

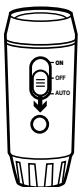

AUTO The night light (at base of handheld torch) will automatically turn on when the sensor detects low light conditions, and turn off when sufficient light is detected.

The power failure torch will automatically turn on if power to the base is disconnected (ie power failure or wall socket turned off) or if the handheld torch is removed from the base.

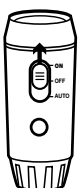

ON The night light remains permanently illuminated.
The handheld torch turns on when no longer connected to the base.